

The RIS-STOP-2SF-R is suitable for 2" pressure delivery above ground installations. It incorporates many proven RIS-STOP features and now includes a more compact 4 bolt flange body allowing greater maximum tank fluid levels.

RIS Stop 2SF-R

KEY FEATURES

- Cartridge construction for easy installation & access via the tank lid welding socket supplied (2in BSPP)
- Very high flow capacity (50% greater than some competitors' products)
- Pressure delivery up to 8 bar maximum
- 2 Stage Shut-off giving warning of complete closure over last 15mm of level change
- Effective at low flow rates, flow operating range 10 - 550 Litres per minute
- 4 Bolt flanged body for versatile inlet pipework combinations without the need for a union
- No dynamic seals - promoting long term reliability
- On site inspection and testing via access cap without pipework disassembly
- Note: Splash feed design suitable for diesel and heating oils
- Acts as anti-syphon valve in normally closed position
- Optional adjustable kit - RIS-STOP-2/3AF-KIT for tanks requiring adjustment to the float shut-off level.
- Optional test plug for isolating inlet pipework incorporates 1/4" gauge port
- Weld in sockets options: alternative materials such as aluminium or stainless steel
- Optional 1.5"/2" BSP male or 1.5"/2" BSP female inlet flange adaptors - please see over the page for details
- These valves are not suitable alternatives for true 'Shut off valves' and should not be used in continuously pressurised systems.



Risbridger Ltd, 25 Trowers Way, Holmethorpe Industrial Estate, Redhill, Surrey. RH1 2LH
 Tel: +44 (0) 8456 44 23 23 Fax: +44 (0) 8456 44 24 53
 email: info@risbridger.com - www.risbridger.com

INSTALLATION

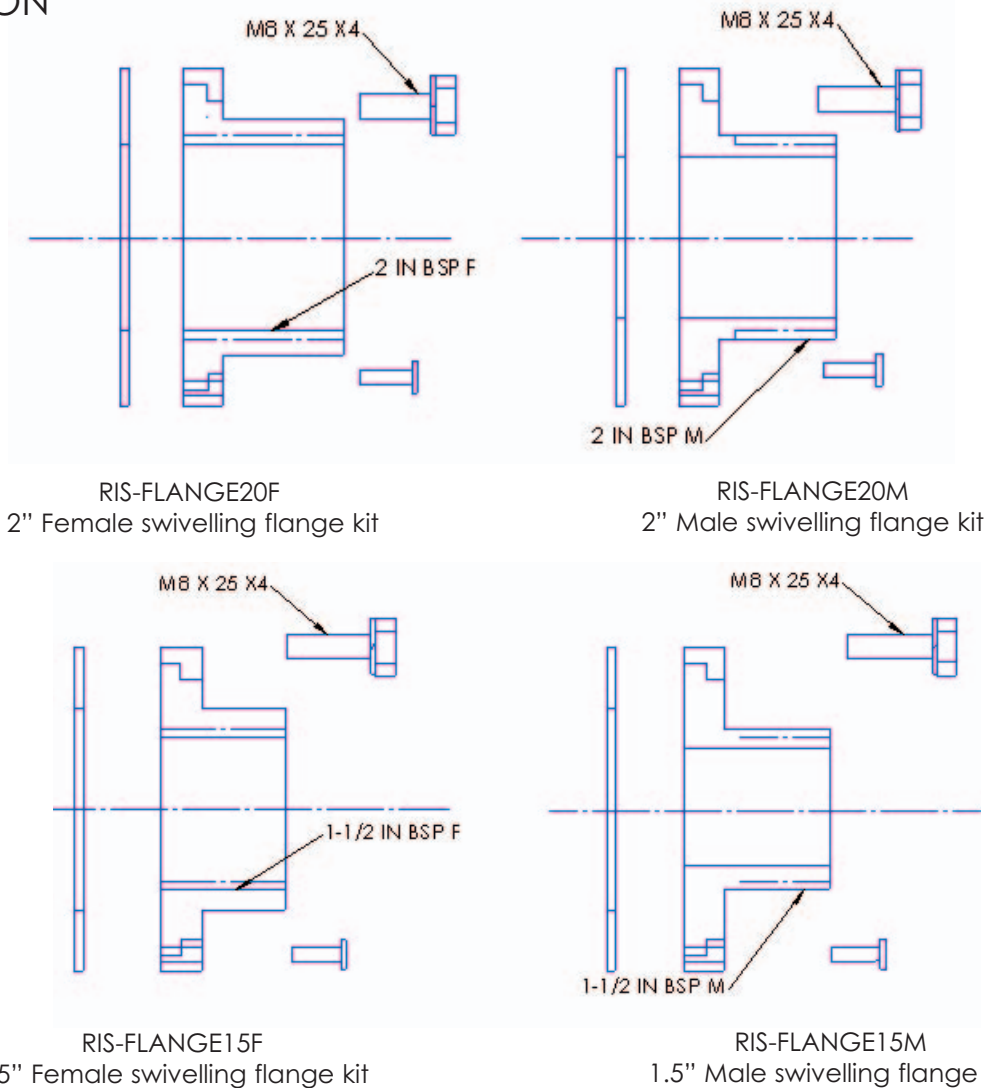

OPTIONAL INLET FLANGES

- The Kits shown above come complete with high quality stainless steel bolt set and composite gasket.
- Split flange design allows correct bolt alignment without tightened threaded joint adjustments. A removable clevis pin locks the square flange to the core for valve joint assembly or disassembly with standard tools.

TESTING

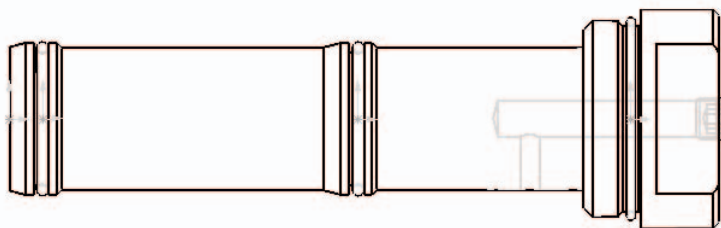

Stock code 4100 - RIS-STOP-2 TEST PLUG

- Allows inlet pipework to be isolated for leakage testing by substitution of the valve cartridge. A 1/4" BSP gauge port is provided.
- Compatible with RIS-STOP-2SF, RIS-STOP-2SF-S, RIS-STOP-2SF-F, and current RIS-STOP-2SF-R valves.

